

GMS

Funding Solutions

Presentation to the Town Council of the
Borough of Chambersburg
JUNE 27, 2016

*PURSUIT OF 2016 MULTIMODAL
TRANSPORTATION FUND GRANT*

MTF Overview

Multimodal Transportation Fund (MTF)

- Funded through **Act 89-2013**, highly competitive, available annually
- Two MTF programs – Commonwealth Financing Authority (CFA)/Department of Community and Economic Development (DCED) and PennDOT
- Eligible projects:
 - Projects coordinating local land use with transportation assets to enhance communities, e.g., bus stops, **bicycle lanes**, highway noise and sound barriers, etc.
 - Streetscape, lighting, sidewalk enhancement and pedestrian safety, e.g., crosswalks, pedestrian and traffic signals, signage, etc.
 - Improving connectivity or utilization of existing transportation assets, e.g., coordinated transit service, rail freight sidings, airport taxiways, access roads, etc.
 - Transit-oriented development, e.g., transit shelters, rail station development, etc.

MTF Overview, con't.

- Eligible applicants: **Municipalities**, councils of governments, businesses, economic development organizations, public transportation authorities, ports and rail/freights owners and operators
- Eligible costs: acquisition, **construction**, **demolition**, clearing/grading, environmental site assessments, **engineering/design**, **contingencies**
- Maximum grant – 70% of project cost / Minimum local match – 30% of project cost
- Maximum grant award - \$3 million

Proposed MTF Project

“Chambersburg Multimodal Integration Project”

- Multi-faceted, multimodal integration plan aimed at safely connecting motorists, cyclists and pedestrians to key areas throughout the community, including:
 - Phase I – Downtown Pedestrian Network Integration
 - Phase II – Rhodes Drive Reconstruction
 - Phase III – Bike/Ped Safety Improvements (Sharrows and Crosswalks)
 - Phase IV – American with Disabilities Act (ADA) Curb Ramps
- Total cost: \$1.1 million
- Recommended MTF request: \$776,678

Phase I

Phase I – Downtown Pedestrian Network Integration

- Estimated cost: \$388,421
- Goal: Provide safe pedestrian linkages to downtown at and around the Central Parking Lot; create a gateway
- Scope of work: installation of lighting, clearly delineated pedestrian walkway, curbs and ADA-curb ramps, and associated signage
- Consistent with the *Chambersburg Downtown Master Plan - Pedestrian Access and Parking Efficiency, Alley Enhancement, and Gateway Concepts*
- Other participating stakeholders: Chambersburg Area Development Corporation (CADC)

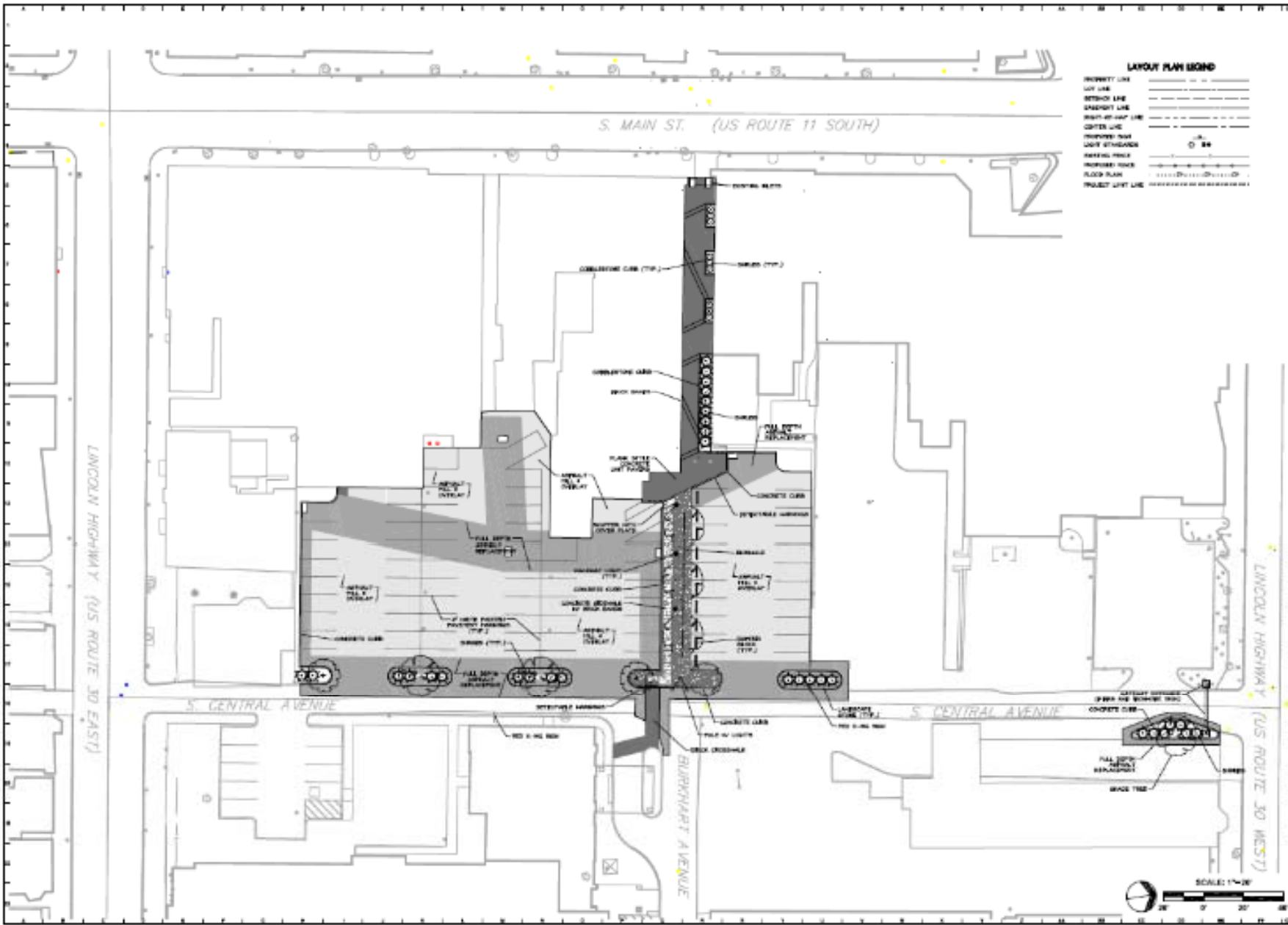

LAYOUT PLAN LEGEND

PROPERTY LINE	---
LOT LINE	----
SETBACK LINE	-----
STREET LINE	-----
RIGHT-OF-WAY LINE	-----
CENTER LINE	-----
IMPROVED SIDE	-----
UNIMPROVED SIDE	-----
PROJECT LOT LINE	-----
REPAIRING ROAD	-----
IMPROVED ROAD	-----
BLOCK PLAN	-----



DERCK & EDSON
 CIVIL, MECHANICAL & ELECTRICAL ENGINEERS
 1000000000

LAYOUT PLAN
 PROJECT NAME
 Central Parking Lot Pedestrian Walkway
 Stormwater Project
 100 S. Central Ave.
 Chambersburg, PA 17021
 (Chambersburg) (717) 261-1000

DATE	NO.

Sheet No. **C-103**



Phase II

Phase II – Rhodes Drive Reconstruction

- Estimated cost: \$257,845
- Goal: To maintain a state of good repair on a key Borough roadway, which serves as a first-responder route for emergencies on the south side of town, as well as a staging area for various events, parades, etc.; establish the Borough's first "green street"
- Scope of work: Completely reconstruct the Rhodes Dr. roadway, replace two stormwater inlet structures and associated piping, install a sidewalk network with pervious materials and lighting
- Consistent with the *Chambersburg Downtown Master Plan – Green Streets Concept*
- Other participating stakeholders: Franklin County Conservation District



Existing Conditions
(1 of 4)





Phase III

Phase III – Bike/Ped Safety Improvements (Sharrows and Crosswalks)

- Estimated cost: \$113,275
- Goal: Provide for enhanced safety of pedestrian and bicycle movement throughout town; promote cycling as an alternative form of transportation
- Scope of work: Install 41 crosswalks with appropriate signage and 118 shared lane markings in strategic locations throughout town
- Consistent with the *Chambersburg Downtown Master Plan* – “emphasiz[ing] that Chambersburg is a bike and pedestrian friendly community.”

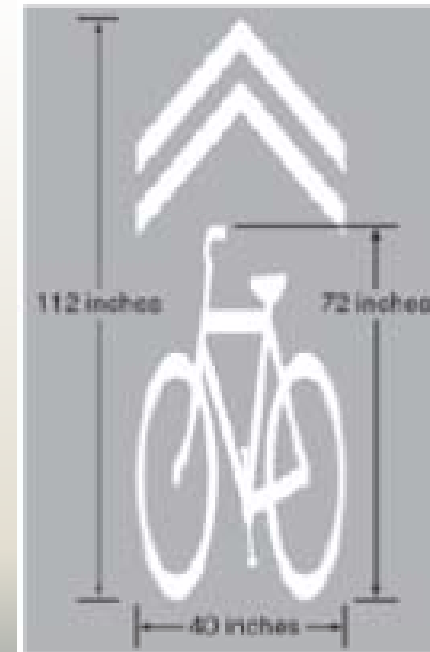

Phase IV

Phase IV – ADA Curb Ramps

- Estimated cost: \$350,000
- Goal: Enhancing safety; achieving Town Council's goal dating back to the early 2000's to make every Borough intersection ADA compliant
- Scope of work: Installation of 125 new curb ramps and 350 new detectable warning mats throughout the Second Ward



Next steps



- Request Town Council to consider passage of a Resolution to Apply, a required exhibit of the MTF application
- Application submission – July 29, 2016
- Expected award announcements – Fall 2016
- Should an award be granted, receipt of fully executed grant agreement – December 2016
- Final design complete – March 2017
- Construction commencement – April 2017

Questions?

Thank you.